

FIBERGLASS SHELTERS, ENCLOSURES & BUILDINGS



PRODUCT CATALOG

585.735.9668
Custom Fiberglass Solutions

VPCFIBERGLASS.COM



DURABLE BUILD

- Insulated
- Maintenance-Free
- Corrosion-Resistant
- Fully Assembled
- Weatherproof
- Single-Piece Construction
- 130 MPH Wind Load
- 40 PSF Snow Load
- Variety of Sizes
- In Stock & Ready to Ship

Standard Equipment Enclosures

ENGINEERED TO ENDURE, DESIGNED TO PROTECT.

VPC **Enduro Fiberglass Shelters** are tough, corrosion-resistant enclosures designed to protect critical equipment in harsh environments.

Sizes

Standard Sizes: 29" x 29" up to 72" x 72"
Custom sizes available upon request.

Custom Options

- Designed to your specifications
- In-house engineering and design support

Standard Features

- Fiber-reinforced Plastic (FRP) Construction
- Isophthalic Polyester Resin
- UV-resistant Gel Coat Exterior
- UV-resistant Gel Coat Interior
- 1" Thick Rigid Polyisocyanurate Insulation (***R-7 insulation value***)
- Integral Base Mounting Flange (internal vs external model dependent)

Standard Options

- Fixed Louver Ventilation
- Neoprene/EPDM Door Gaskets/Seals
- Stainless Steel Lifting Lugs (Model dependent)
- Stainless Steel Lockable T-Handle/Pad Lockable Hasp (model dependent)
- Stainless Steel Hinges

Enclosure Accessories

Unlimited Ways to Customize

Enduro Shelters Optional Customizations

Stainless Steel Heater with Thermostat

LED Lighting Package with Interior or Exterior Switch

Weatherproof Exterior Light Switch

585 Exhaust Fan with Louvers

Door-Activated Switch for Light or Fan

60 CFM Exhaust Blower with Thermostat

100 Amp Main Lug Load Center - 4 Breakers

Power Feed Junction Box

Equipment Mounting Board (30" x 36")

Special Color (Standard is Beige)

12" x 12" Window in Door

20 Amp GFI Duplex Outlet

3/8" Thick Integral Fiberglass Floor

Unlimited Ways to Customize

Contact Engineered Sales

For a Custom Quote: 585.735.9668



Standard Equipment Enclosures

General Specifications – Consolidated Chart

CABINET STYLE SHELTERS							
Shelter Model	Length	Width	Height	Access Type	Locking Type	Door Opening	Details
Enduro M50	29 IN	29 IN	35 IN	Single Door	Three point locking latch w/ handle	WIDTH: 22 IN HEIGHT: 27.25 IN	<ul style="list-style-type: none"> • Pad mounted • Anchor in place • Cabinet style • Accessed from one side • Locking T handle
Enduro M100	37.75 IN	37.75 IN	50 IN	Single Door + Top Hatch Door	Three point locking latch w/ handle	WIDTH: 27 IN HEIGHT: 43.375 IN	<ul style="list-style-type: none"> • Pad mounted • Anchor in place • Cabinet style • Accessed from exterior • 45° Flip Top Lid Ext.
Enduro M150	36 IN	26 IN	54 IN	Single Door	Three point locking latch w/ handle	WIDTH: 26 IN HEIGHT: 41.375 IN	<ul style="list-style-type: none"> • Pad mounted • Anchor in place • Cabinet style • Accessed from exterior • Accessed from one side
Enduro M200	45 IN	45 IN	74 IN	Single Door	Three point locking latch w/ handle	WIDTH: 37.75 IN HEIGHT: 64.5 IN	<ul style="list-style-type: none"> • Pad mounted • Anchor in place, • Accessed from exterior or walk in (<i>equipment dependent</i>) • Accessed from one side
Enduro M300	60 IN	60 IN	84.5 IN	Single Door	Three point locking latch w/ handle	WIDTH: 38 IN HEIGHT: 64.5 IN	<ul style="list-style-type: none"> • Pad mounted • Anchor in place • Walk in (<i>equipment dependent</i>) • Accessed from one side.
Enduro M600	72 IN	72 IN	84.5 IN	Single Door	Three point locking latch w/ handle	WIDTH: 50.125 IN HEIGHT: 64.5 IN	<ul style="list-style-type: none"> • Pad mounted • Anchor in place • Accessed from exterior or walk in (<i>equipment dependent</i>) • Accessed from one side.
Enduro M5427	54 IN	27 IN	78 IN	Single Door	Pad lockable SS handle	WIDTH: 36 IN HEIGHT: 70 IN	<ul style="list-style-type: none"> • Pad mounted • Anchor in place • Accessed from exterior • Accessed from one side.

Standard Equipment Enclosures

General Specifications – Consolidated Chart

CLAM SHELL / FLIP TOP / TILT BACK / DOUBLE / GULL WING							
Shelter Model	Length	Width	Height	Access Type	Locking Type	Door Opening	Details
Enduro M1630	16 IN	30 IN	50 IN	Clam Shell / Flip Top	304 SS Pad lockable hasp	WIDTH: 27 IN HEIGHT: 47 IN	<ul style="list-style-type: none"> • Pad mounted • Anchor in place • Cabinet style • Accessed from exterior • Accessed from one side
Enduro M400	60 IN	48 IN	43 IN	Tilt Back		WIDTH: 46 IN HEIGHT: 30	<ul style="list-style-type: none"> • Pad mounted • Tilt-Back on exterior base flange for complete access to inside equipment • Accessed from exterior
Enduro M429	47 IN	47 IN	29 IN	Tilt Back	304 SS Pad lockable hasp	WIDTH: 41 IN HEIGHT: 34.69 IN	<ul style="list-style-type: none"> • Pad mounted • Tilt-Back on Interior Base Flange for complete access to inside equipment • Accessed from exterior
Enduro M433	49.5 IN	38 IN	36 IN	Clam Shell / Flip Top	304 SS Pad lockable hasp	WIDTH: 49.6 IN HEIGHT: 63.375 IN	<ul style="list-style-type: none"> • Pad mounted, • Anchor in place • Cabinet style • Accessed from exterior • Accessed from one side
Enduro M400G	60 IN	48 IN	43 IN	Gull Wing (Similar to Clam Shell)		WIDTH: 50.166 IN HEIGHT: 46.062 IN	<ul style="list-style-type: none"> • Pad mounted • Gull wing jig cutout version of M400 • Anchor in place • Accessed from one side.
Enduro 400GX	60 IN	48 IN	43 IN	2X Gull Wings		WIDTH: 50.875 IN HEIGHT: 44 IN	<ul style="list-style-type: none"> • Pad mounted 2X gull wing jig cutout version of M400 • Accessed from both sides.

Standard Equipment Enclosures

Enduro M50

Unlimited Ways to Customize



Enduro M50



2D DRAWINGS:

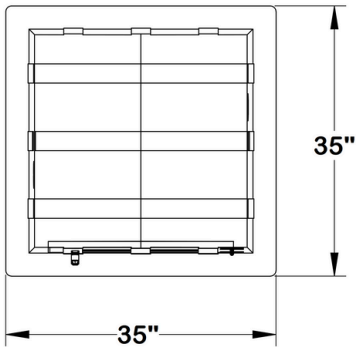

TOP VIEW

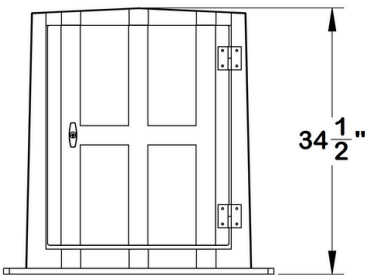

FRONT VIEW

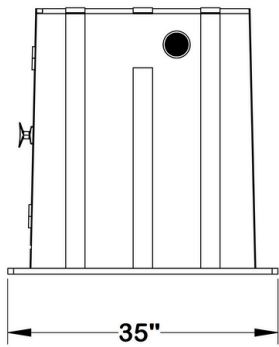

SIDE VIEW

Enduro M50

Dimensions

Length: 29 IN

Width: 29 IN

Height: 35 IN

Door Opening Width: 22 IN

Door Opening Height: 27.25 IN

Model Details

- Pad Mounted
- Anchor in Place
- Cabinet Style
- Accessed from One Side
- Locking T Handle
- Screened Fixed Louver
- 4 IN External Mounting Flange

Standard Properties

- *Insulated*
- *Maintenance-Free*
- *Corrosion-Resistant*
- *Fully Assembled*
- *Weatherproof*
- *Single-Piece Construction*
- *130 MPH Wind Load*
- *40 PSF Snow Load*
- *In Stock, Ready to Ship*

Standard Equipment Enclosures

Enduro M100

Unlimited Ways to Customize



Enduro M100



2D DRAWINGS:

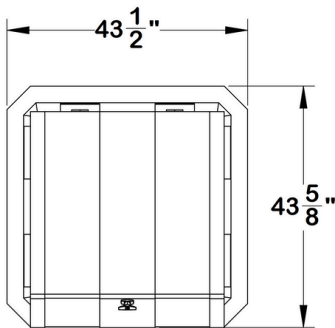

TOP VIEW

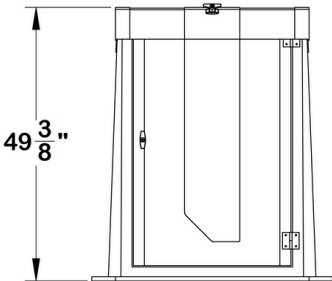

FRONT VIEW

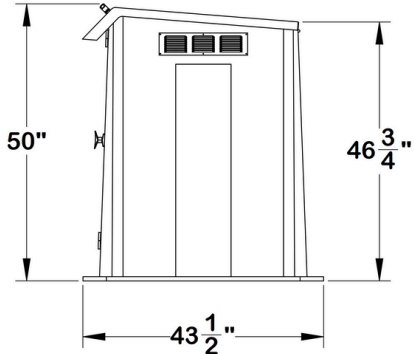

SIDE VIEW

Enduro M100

Dimensions

Length: 37.75 IN

Width: 37.75 IN

Height: 50 IN

Door Opening Width: 27 IN

Door Opening Height: 43.375 IN

Model Details

- Pad mounted
- Anchor in place
- Cabinet style
- Accessed from exterior
- **45° Flip Top Lid Ext.**
- Screened Fixed Louver
- 3 IN External Mounting Flange

Standard Properties

- *Insulated*
- *Maintenance-Free*
- *Corrosion-Resistant*
- *Fully Assembled*
- *Weatherproof*
- *Single-Piece Construction*
- *130 MPH Wind Load*
- *40 PSF Snow Load*
- *In Stock, Ready to Ship*

Standard Equipment Enclosures

Enduro M150

Unlimited Ways to Customize



2D DRAWINGS:

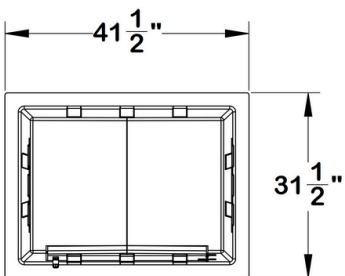

TOP VIEW

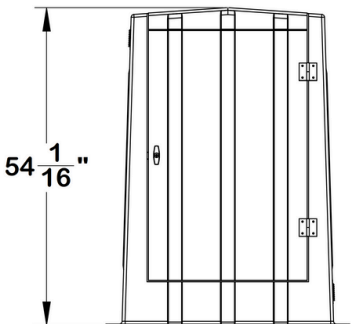

FRONT VIEW

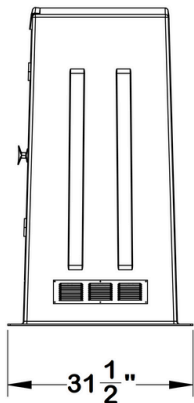

SIDE VIEW

Enduro M150

Dimensions

Length: 36 IN

Width: 26 IN

Height: 54 IN

Door Opening Width: 26 IN

Door Opening Height: 41.375 IN

Model Details

- Pad Mounted
- Anchor in Place
- Cabinet Style
- Accessed From Exterior
- Accessed From One Side
- Screened Fixed Louver Vents
- 3 IN External Mounting Flange

Standard Properties

- *Insulated*
- *Maintenance-Free*
- *Corrosion-Resistant*
- *Fully Assembled*
- *Weatherproof*
- *Single-Piece Construction*
- *130 MPH Wind Load*
- *40 PSF Snow Load*
- *In Stock, Ready to Ship*

Standard Equipment Enclosures

Enduro M1630 - Designed especially to house SCADA systems.

Unlimited Ways to Customize



2D DRAWINGS:

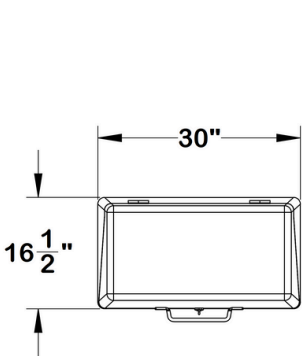

TOP VIEW

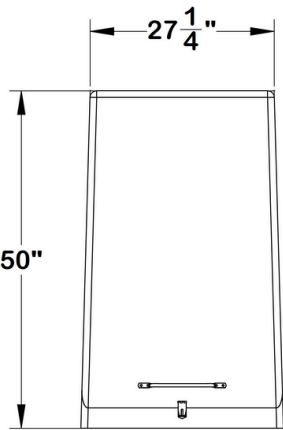

FRONT VIEW

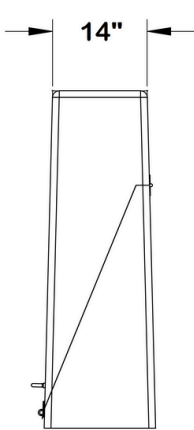

SIDE VIEW

Enduro M1630

Dimensions

Length: 16 IN
Width: 30 IN
Height: 50 IN
Door Opening Width: 27.375 IN
Door Opening Height: 47 IN

Model Details

- Pad Mounted
- Anchor in Place
- Cabinet Style
- Accessed From Exterior
- Accessed From One Side

Standard Properties

- Insulated
- Maintenance-Free
- Corrosion-Resistant
- Fully Assembled
- Weatherproof
- Single-Piece Construction
- 130 MPH Wind Load
- 40 PSF Snow Load
- In Stock, Ready to Ship

Standard Equipment Enclosures

Enduro M200 - Our most popular shelter for storing monitoring, communications, or electrical equipment.

Unlimited Ways to Customize



Enduro M200

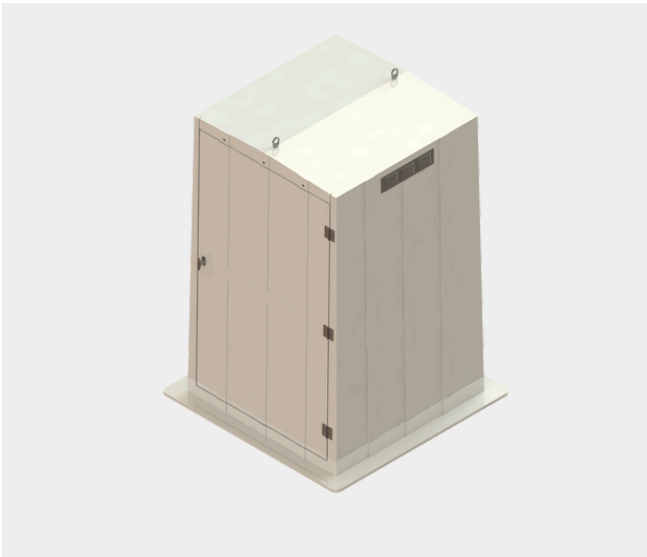

2D DRAWINGS:

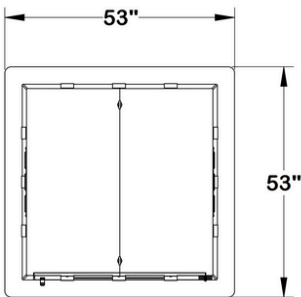

TOP VIEW

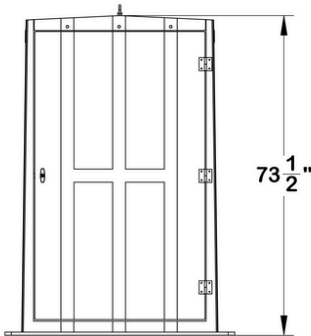

FRONT VIEW

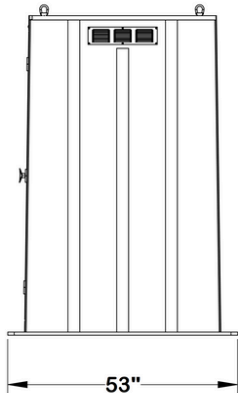

SIDE VIEW

Enduro M200

Dimensions

Length: 45 IN
Width: 45 IN
Height: 74 IN
Door Opening Width: 37.75 IN
Door Opening Height: 64.5 IN

Model Details

- Pad mounted
- Anchor in place,
- Accessed from exterior or walk in
- Accessed from one side
- Screened fixed louver Vents
- 3 IN Ext. Mounting Flange

Standard Properties

- *Insulated*
- *Maintenance-Free*
- *Corrosion-Resistant*
- *Fully Assembled*
- *Weatherproof*
- *Single-Piece Construction*
- *130 MPH Wind Load*
- *40 PSF Snow Load*
- *In Stock, Ready to Ship*

Standard Equipment Enclosures

Enduro M300 - Often used in cellular or antenna shielding.

Unlimited Ways to Customize



Enduro M300



2D DRAWINGS:

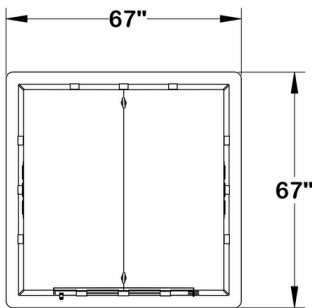

TOP VIEW

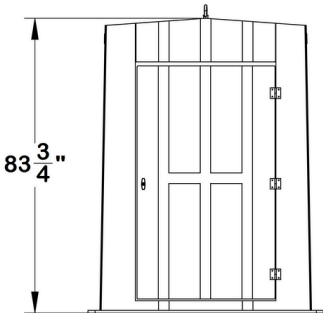

FRONT VIEW

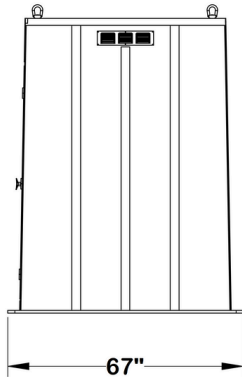

SIDE VIEW

Enduro M300

Dimensions

Length: 60 IN
Width: 60 IN
Height: 84.5 IN
Door Opening Width: 38 IN
Door Opening Height: 64.5 IN

Model Details

- Pad mounted
- Anchor in place
- Walk in (*equipment dependent*)
- Accessed from one side.
- Screened fixed louver Vents
- 4 IN ext. mounting flange

Standard Properties

- *Insulated*
- *Maintenance-Free*
- *Corrosion-Resistant*
- *Fully Assembled*
- *Weatherproof*
- *Single-Piece Construction*
- *130 MPH Wind Load*
- *40 PSF Snow Load*
- *In Stock, Ready to Ship*

Standard Equipment Enclosures

Enduro M400 - Tilt shelter with lift handle and piano hinges.

Unlimited Ways to Customize



Enduro M400



2D DRAWINGS:

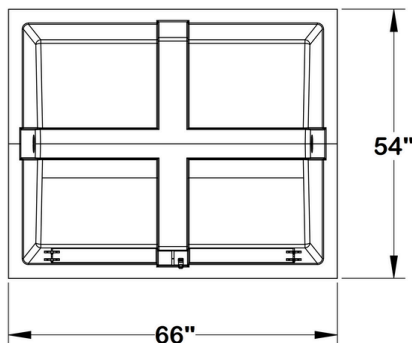

TOP VIEW

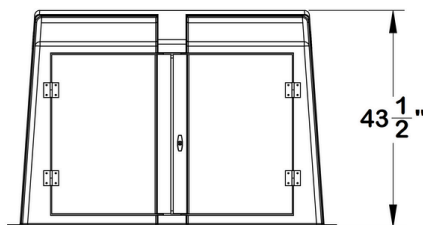

FRONT VIEW

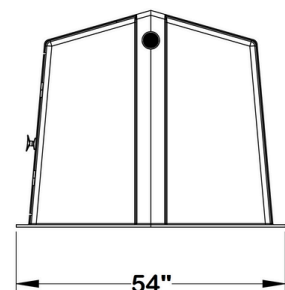

SIDE VIEW

Enduro M400

Dimensions

Length: 60 IN

Width: 48 IN

Height: 43 IN

Door Opening Width: 46.75

Door Opening Height: 30.75

Model Details

- Pad mounted
- Tilt-Back on exterior base flange for complete access to inside equipment
- Accessed from exterior
- SS lifting handle

Standard Properties

- *Insulated*
- *Maintenance-Free*
- *Corrosion-Resistant*
- *Fully Assembled*
- *Weatherproof*
- *Single-Piece Construction*
- *130 MPH Wind Load*
- *40 PSF Snow Load*
- *In Stock, Ready to Ship*

Standard Equipment Enclosures

Enduro M400G - A versatile single gull wing shelter able to easily access well heads, pumps, valves, and pipes.

Unlimited Ways to Customize



2D DRAWINGS:

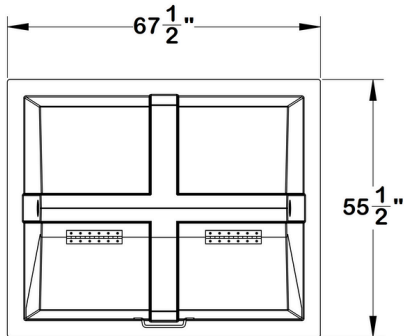

TOP VIEW

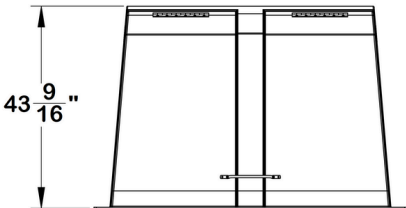

FRONT VIEW

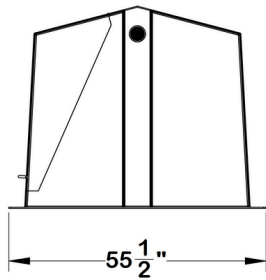

SIDE VIEW

Enduro M400G

Dimensions

Length: 60 IN
Width: 48 IN
Height: 43 IN
Door Opening Width: 50.166 IN
Door Opening Height: 46.0625 IN

Model Details

- Pad mounted
- Tilt-Back on exterior base flange for complete access to inside equipment
- Accessed from exterior
- SS lifting handle
- 4 IN ext. mounting flange

Standard Properties

- *Insulated*
- *Maintenance-Free*
- *Corrosion-Resistant*
- *Fully Assembled*
- *Weatherproof*
- *Single-Piece Construction*
- *130 MPH Wind Load*
- *40 PSF Snow Load*
- *In Stock, Ready to Ship*

Standard Equipment Enclosures

Enduro M400GX - One or both sides of the Enduro 400GX can be opened, making access to the pump convenient!

Unlimited Ways to Customize



Enduro M400GX



2D DRAWINGS:

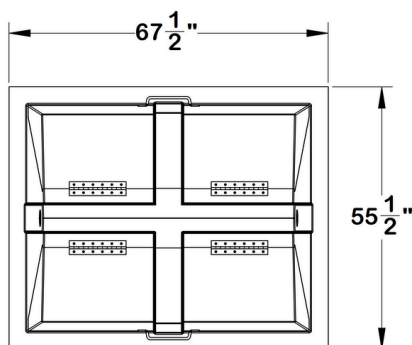

TOP VIEW

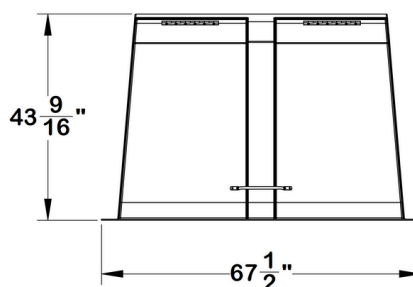

FRONT VIEW

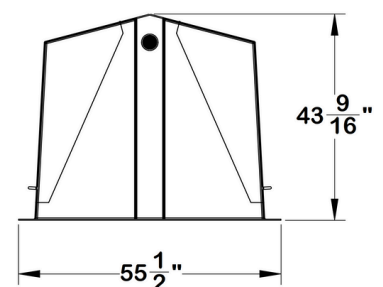

SIDE VIEW

Enduro M400GX

Dimensions

Length: 60 IN

Width: 48 IN

Height: 43 IN

Door Opening Width: 50.875 IN

Door Opening Height: 44 IN

Model Details

- Pad mounted 2X gull wing jig cutout version of M400
- Accessed from both sides.
- SS lifting handle
- 4 IN ext. mounting flange

Standard Properties

- *Insulated*
- *Maintenance-Free*
- *Corrosion-Resistant*
- *Fully Assembled*
- *Weatherproof*
- *Single-Piece Construction*
- *130 MPH Wind Load*
- *40 PSF Snow Load*
- *In Stock, Ready to Ship*

Standard Equipment Enclosures

Enduro M429 - Sized perfectly for many different pump and backflow prevention applications.

Unlimited Ways to Customize



Enduro M429

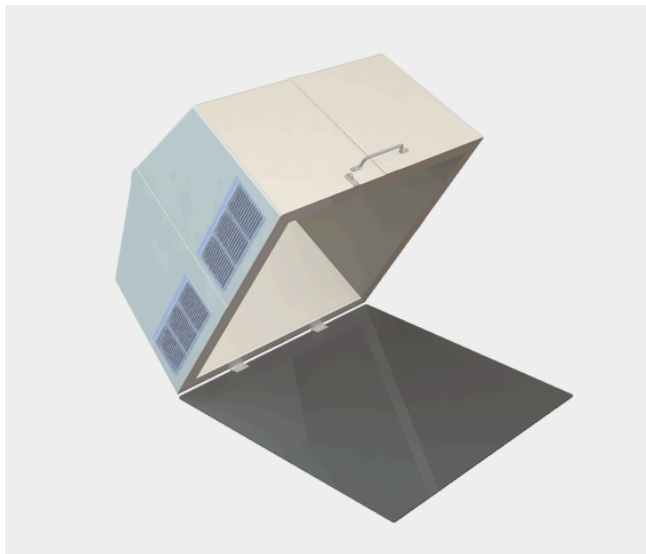

2D DRAWINGS:

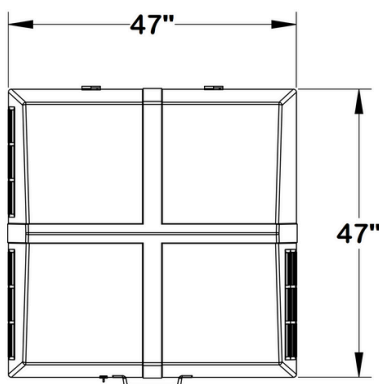

TOP VIEW

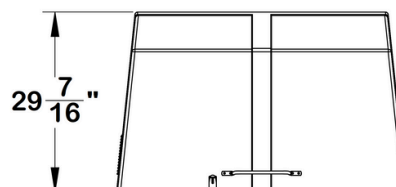

FRONT VIEW

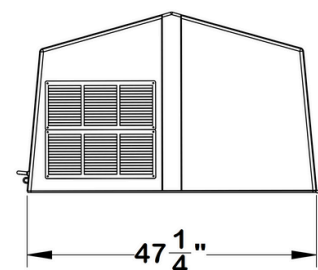

SIDE VIEW

Enduro M429

Dimensions

Length: 47 IN

Width: 47 IN

Height: 29 IN

Door Opening Width: 41 IN

Door Opening Height: 34.69 IN

Model Details

- Pad mounted
- Tilt-Back on Interior Base Flange for complete access to inside equipment
- Accessed from exterior
- 1/4" Pultruded floor
- Screened fixed louver vents

Standard Properties

- *Insulated*
- *Maintenance-Free*
- *Corrosion-Resistant*
- *Fully Assembled*
- *Weatherproof*
- *Single-Piece Construction*
- *130 MPH Wind Load*
- *40 PSF Snow Load*
- *In Stock, Ready to Ship*

Standard Equipment Enclosures

Enduro M433 - Shelter features stainless steel rear hinges for flip-top access, with prop bars securing the lid during maintenance or repair.

Unlimited Ways to Customize



Enduro M433



2D DRAWINGS:

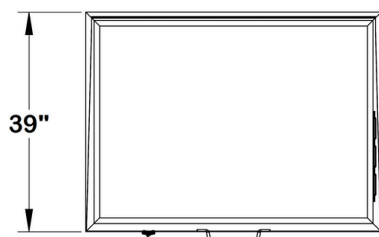

TOP VIEW

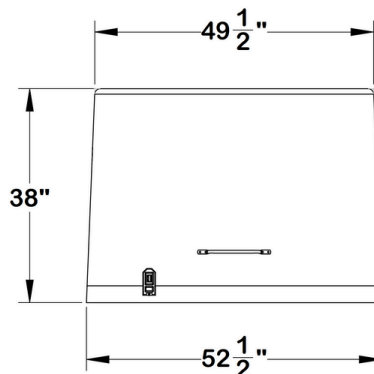

FRONT VIEW

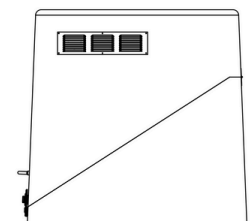

SIDE VIEW

Enduro M433

Dimensions

Length: 49.5 IN

Width: 38 IN

Height: 36 IN

Door Opening Width: 49.68 IN

Door Opening Height: 63.375 IN

Model Details

- Pad mounted
- Tilt-Back on Interior Base Flange for complete access to inside equipment
- Accessed from exterior
- 1/4" Pultruded floor
- Screened fixed louver vents

Standard Properties

- *Insulated*
- *Maintenance-Free*
- *Corrosion-Resistant*
- *Fully Assembled*
- *Weatherproof*
- *Single-Piece Construction*
- *130 MPH Wind Load*
- *40 PSF Snow Load*
- *In Stock, Ready to Ship*

Standard Equipment Enclosures

Enduro M600 - Spacious 72" square, maintenance-free shelter for water, wastewater, communications, industrial, electrical, and municipal applications.



Enduro M600



2D DRAWINGS:

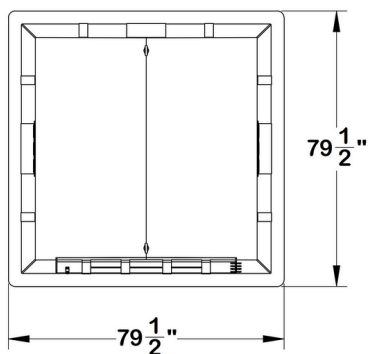

TOP VIEW

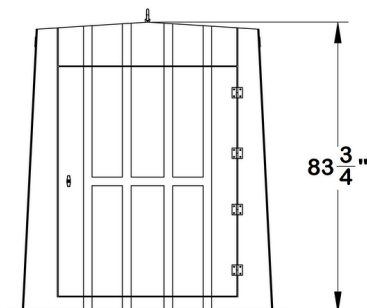

FRONT VIEW

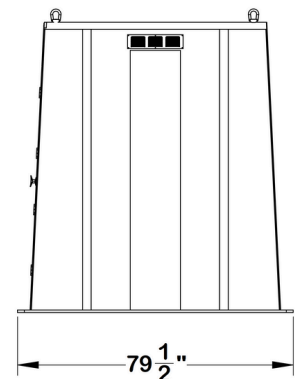

SIDE VIEW

Enduro M600

Dimensions

Length: 72 IN

Width: 72 IN

Height: 84.5 IN

Door Opening Width: 50.125 IN

Door Opening Height: 64.5 IN

Model Details

- Pad mounted
- Anchor in place
- Accessed from exterior or walk in (*equipment dependent*)
- Accessed from one side.
- Screened fixed louver vents
- 4 IN ext. mounting flange

Standard Properties

- *Insulated*
- *Maintenance-Free*
- *Corrosion-Resistant*
- *Fully Assembled*
- *Weatherproof*
- *Single-Piece Construction*
- *130 MPH Wind Load*
- *40 PSF Snow Load*
- *In Stock, Ready to Ship*

Standard Equipment Enclosures

Enduro M5427 - The fully insulated Model 5427 is a durable, secure solution for industries like water, telecom, energy, and oil and gas.

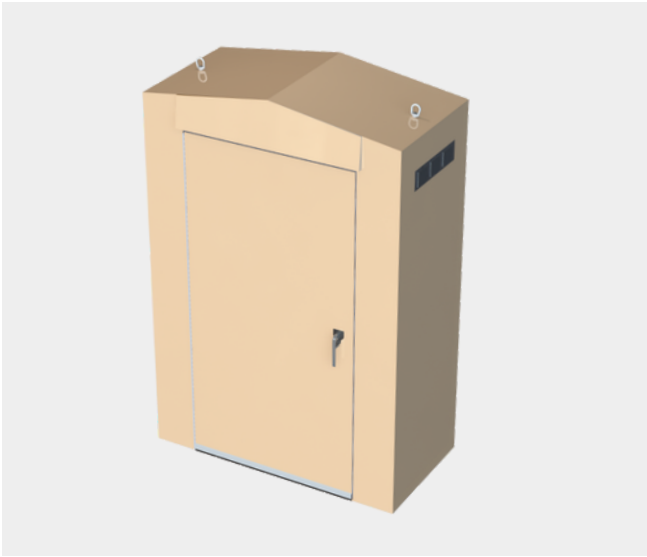

2D DRAWINGS:

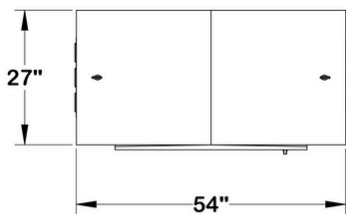

TOP VIEW

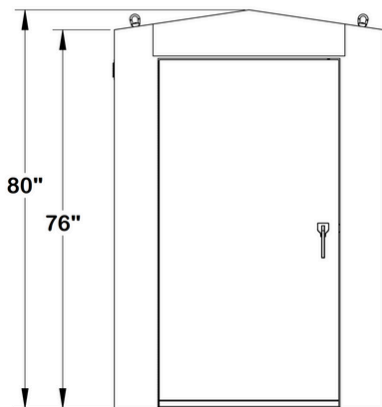

FRONT VIEW

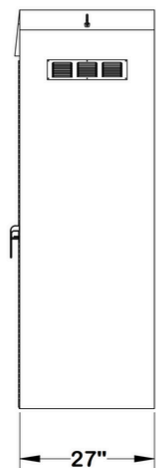

SIDE VIEW

Enduro M5427

Dimensions

Length: 54 IN
Width: 27 IN
Height: 78 IN
Door Opening Width: 36 IN
Door Opening Height: 70 IN

Model Details

- Pad mounted
- Anchor in place
- Accessed from exterior
- Accessed from one side.
- Aluminum door sweep with neoprene rubber

Standard Properties

- *Insulated*
- *Maintenance-Free*
- *Corrosion-Resistant*
- *Fully Assembled*
- *Weatherproof*
- *Single-Piece Construction*
- *130 MPH Wind Load*
- *40 PSF Snow Load*
- *In Stock, Ready to Ship*



Standard Buildings

DURABLE, PRE-MOLDED FIBERGLASS STRUCTURES.

A one-piece molded fiberglass building, complete with a built-in door and robust stainless-steel hardware, ensures long-lasting performance with minimal maintenance.

Various Sizes for Versatile Applications:

Standard Sizes: 4' x 6' up to 12' x 14'

Custom Options

- Designed to your specifications
- In-house engineering and design support

Standard Features

- Fiber-reinforced Plastic (FRP) Construction
- Isophthalic Polyester Resin
- UV-resistant Gel Coat Exterior
- UV-resistant Gel Coat Interior
- Rigid Polyisocyanurate Insulation (R7 per inch)
- Integral Base Mounting Flange (internal vs external model dependent)

Common Options

- Load Center
- External Fixed Louvers
- Light w/ Wall Switch
- 3/8" Integral Fiberglass Floor
- Laminated Plywood Interior in Walls/Roof
- Wall Mounted Unistrut
- Windows
- Double Doors

Standard Buildings

General Specifications – Consolidated Chart

Standard Fiberglass Buildings						
Building Model	Length	Width	Height	Access Type	Locking Type	Door Opening
VPC 4x6	72 IN	48 IN	90 IN	Single Door	Three point locking latch w/ handle	WIDTH: 36 IN HEIGHT: 80 IN
VPC 6x8	96 IN	72 IN	90 IN	Single Door	Three point locking latch w/ handle	WIDTH: 36 IN HEIGHT: 80 IN
VPC 8x8	96 IN	96 IN	104 IN	Single Door	Three point locking latch w/ handle	WIDTH: 36 IN HEIGHT: 80 IN
VPC 8x10	120 IN	96 IN	104 IN	Single Door	Three point locking latch w/ handle	WIDTH: 36 IN HEIGHT: 80 IN
VPC 10x10	120 IN	120 IN	106 IN	Single Door	Three point locking latch w/ handle	WIDTH: 36 IN HEIGHT: 80 IN
VPC 10x12	144 IN	120 IN	106 IN	Single Door	Three point locking latch w/ handle	WIDTH: 36 IN HEIGHT: 80 IN
VPC 12x14	168 IN	144 IN	106 IN	Single Door	Three point locking latch w/ handle	WIDTH: 36 IN HEIGHT: 80 IN

Standard Buildings

FRP Building: VPC 4 X 6



VPC 4 X 6

One piece molded building with door and stainless-steel hardware.

Dimensions

Length: 72 IN
Width: 48 IN
Height: 90 IN
Door Opening Width: 36 IN
Door Opening Height: 80 IN

Standard Features

- 3" internal mounting flange
- Isophthalic polyester resin
- UV-resistant gel coat (interior & exterior)
- Rigid polyisocyanurate insulation (R7 per inch)
- Integral base mounting flange (internal or external, model dependent)

Common Optional Features

- Load Center
- External Fixed Louvers
- Light w/ Wall Switch
- 3/8" Integral Fiberglass Floor
- Laminated Plywood Interior in Walls/Roof
- Wall Mounted Unistrut
- Windows
- Double Doors

2D DRAWINGS:

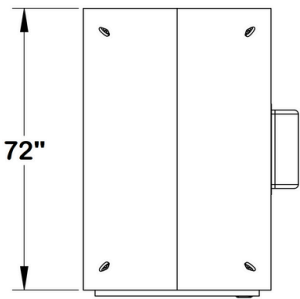

TOP VIEW

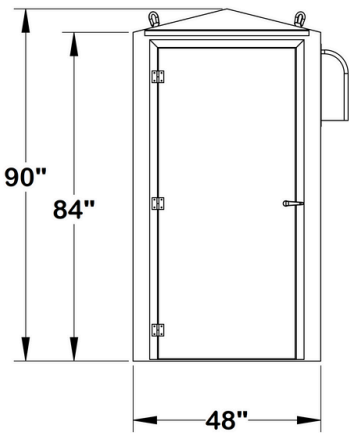

FRONT VIEW

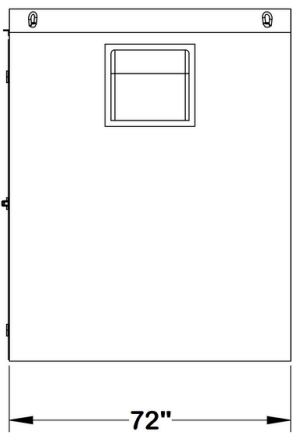

SIDE VIEW

Standard Buildings

FRP Building: VPC 6 X 8

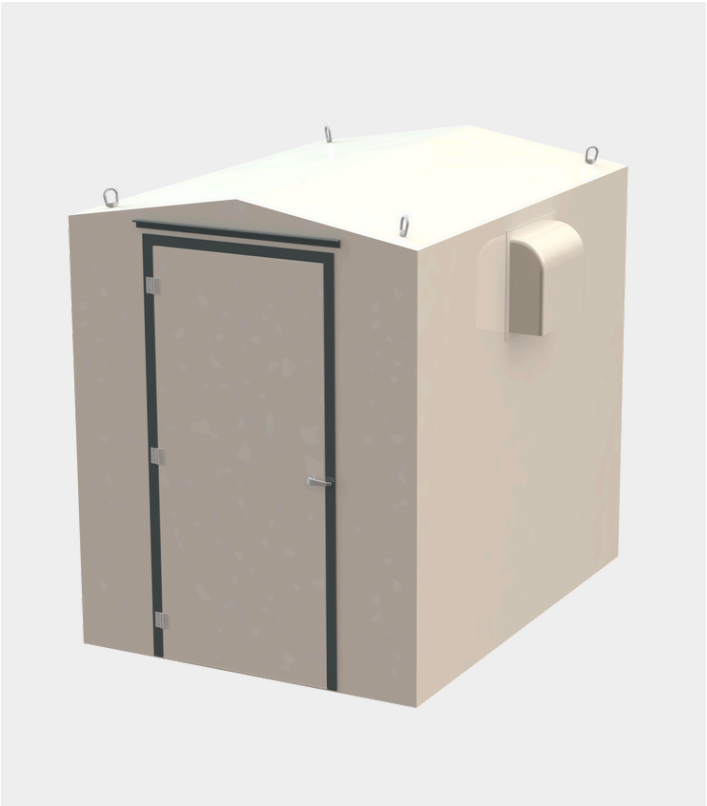

VPC 6 X 8	
One piece molded building with door and stainless-steel hardware.	
Dimensions	
Length: 96 IN Width: 72 IN Height: 90 IN Door Opening Width: 36 IN Door Opening Height: 80 IN	
Standard Features	Common Optional Features
<ul style="list-style-type: none">• 3" internal mounting flange• Isophthalic polyester resin• UV-resistant gel coat (interior & exterior)• Rigid polyisocyanurate insulation (R7 per inch)• Integral base mounting flange (internal or external, model dependent)	<ul style="list-style-type: none">• <i>Load Center</i>• <i>External Fixed Louvers</i>• <i>Light w/ Wall Switch</i>• <i>3/8" Integral Fiberglass Floor</i>• <i>Laminated Plywood Interior in Walls/Roof</i>• <i>Wall Mounted Unistrut</i>• <i>Windows</i>• <i>Double Doors</i>

2D DRAWINGS:

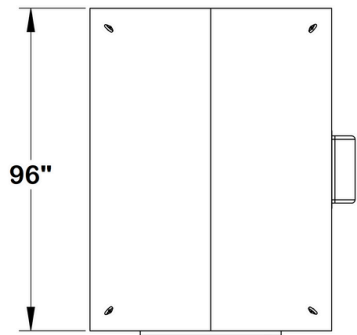

TOP VIEW

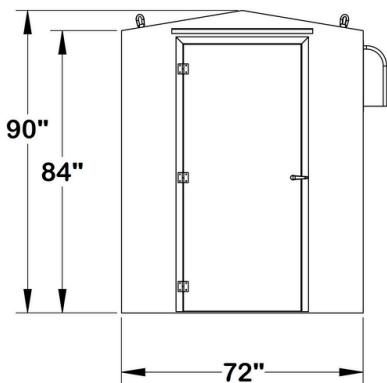

FRONT VIEW

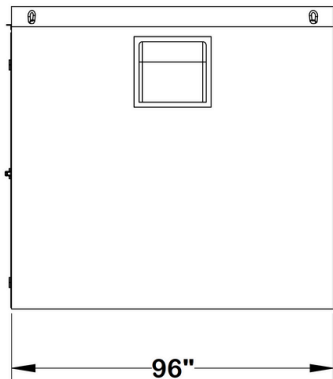

SIDE VIEW

Standard Buildings

FRP Building: VPC 8 X 8

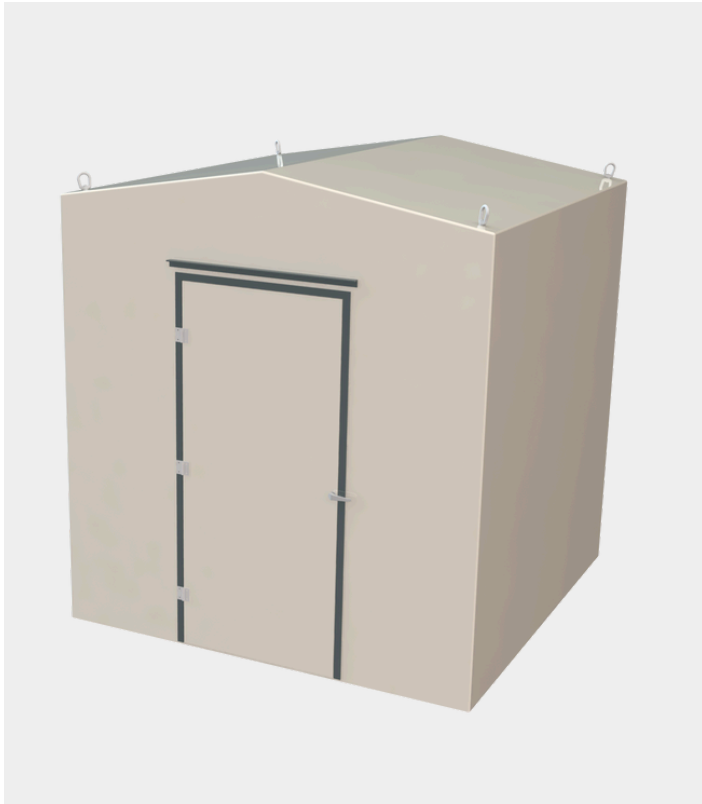

2D DRAWINGS:

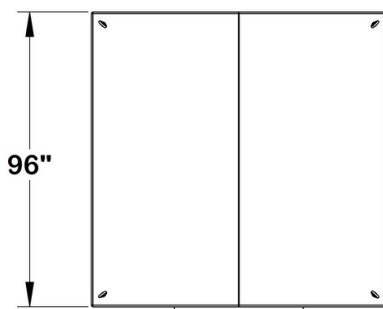

TOP VIEW

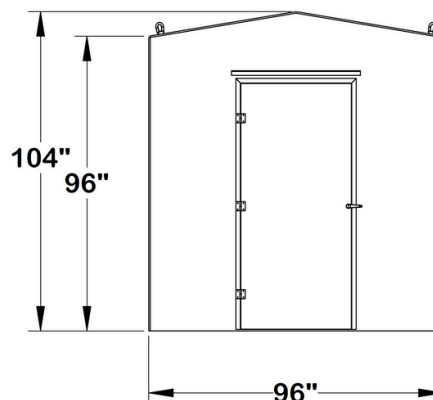

FRONT VIEW

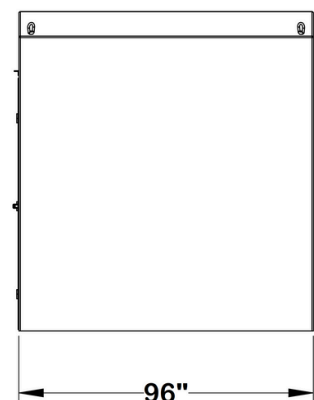

SIDE VIEW

VPC 8 X 8

One piece molded building with door and stainless-steel hardware.

Dimensions

Length: 96 IN
Width: 96 IN
Height: 104 IN
Door Opening Width: 36 IN
Door Opening Height: 80 IN

Standard Features

- 3" internal mounting flange
- Isophthalic polyester resin
- UV-resistant gel coat (interior & exterior)
- Rigid polyisocyanurate insulation (R7 per inch)
- Integral base mounting flange (internal or external, model dependent)

Common Optional Features

- Load Center
- External Fixed Louvers
- Light w/ Wall Switch
- 3/8" Integral Fiberglass Floor
- Laminated Plywood Interior in Walls/Roof
- Wall Mounted Unistrut
- Windows
- Double Doors

Standard Buildings

FRP Building: VPC 8 X 10

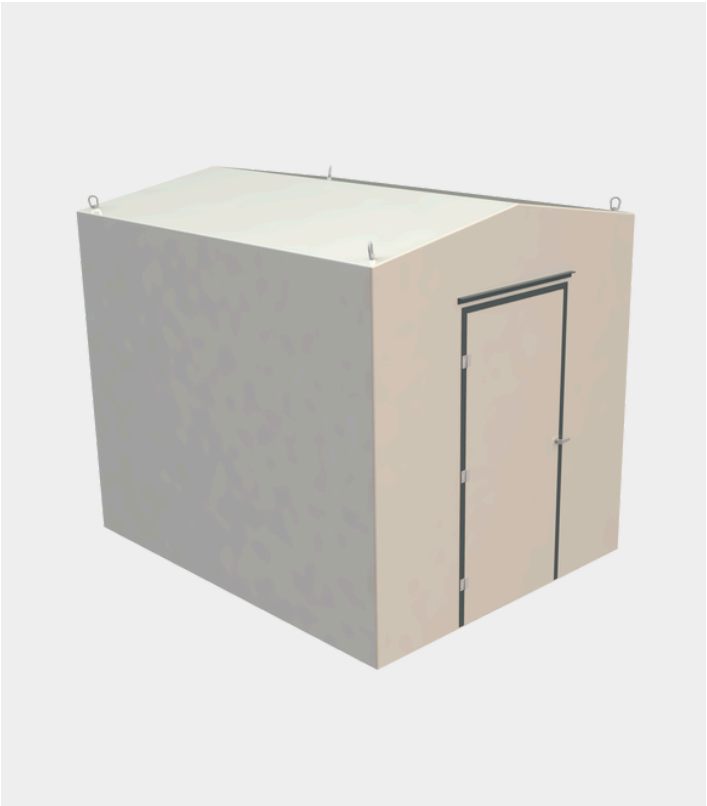

VPC 8 X 10	
One piece molded building with door and stainless-steel hardware.	
Dimensions	
Length: 120 IN Width: 96 IN Height: 104 IN Door Opening Width: 36 IN Door Opening Height: 80 IN	
Standard Features	Common Optional Features
<ul style="list-style-type: none">• 3" internal mounting flange• Isophthalic polyester resin• UV-resistant gel coat (interior & exterior)• Rigid polyisocyanurate insulation (R7 per inch)• Integral base mounting flange (internal or external, model dependent)	<ul style="list-style-type: none">• <i>Load Center</i>• <i>External Fixed Louvers</i>• <i>Light w/ Wall Switch</i>• <i>3/8" Integral Fiberglass Floor</i>• <i>Laminated Plywood Interior in Walls/Roof</i>• <i>Wall Mounted Unistrut</i>• <i>Windows</i>• <i>Double Doors</i>

2D DRAWINGS:

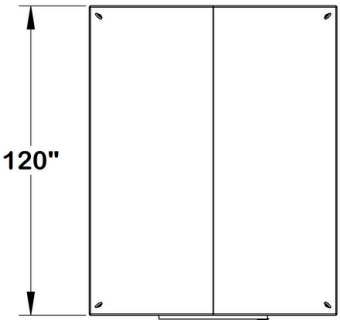

TOP VIEW

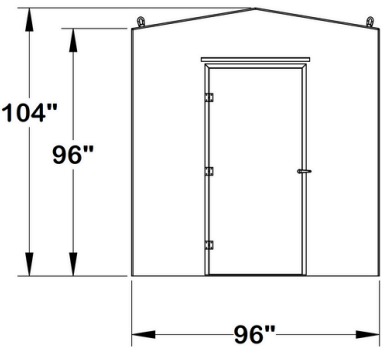

FRONT VIEW

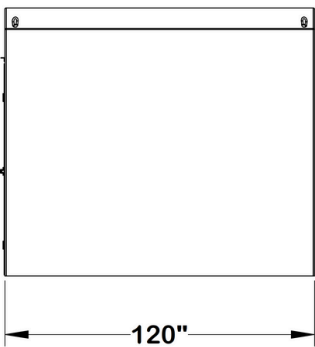

SIDE VIEW

Standard Buildings

FRP Building: VPC 10 X 10

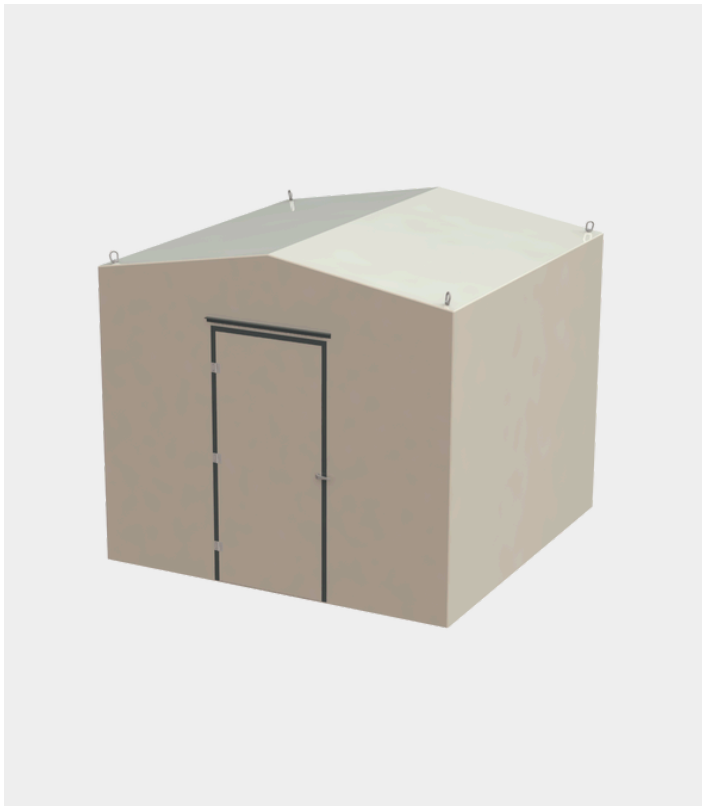

2D DRAWINGS:

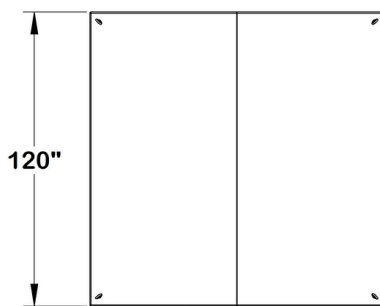

TOP VIEW

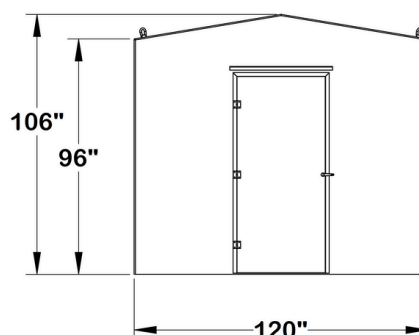

FRONT VIEW

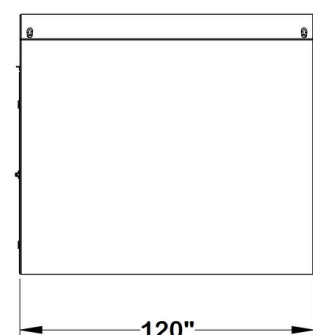

SIDE VIEW

VPC 10 X 10

One piece molded building with door and stainless-steel hardware.

Dimensions

Length: 120 IN

Width: 120 IN

Height: 106 IN

Door Opening Width: 36 IN

Door Opening Height: 80 IN

Standard Features

- 3" internal mounting flange
- Isophthalic polyester resin
- UV-resistant gel coat (interior & exterior)
- Rigid polyisocyanurate insulation (R7 per inch)
- Integral base mounting flange (internal or external, model dependent)

Common Optional Features

- *Load Center*
- *External Fixed Louvers*
- *Light w/ Wall Switch*
- *3/8" Integral Fiberglass Floor*
- *Laminated Plywood Interior in Walls/Roof*
- *Wall Mounted Unistrut*
- *Windows*
- *Double Doors*

Standard Buildings

FRP Building: VPC 10 X 12



2D DRAWINGS:

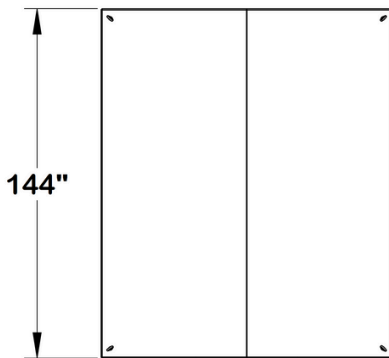

TOP VIEW

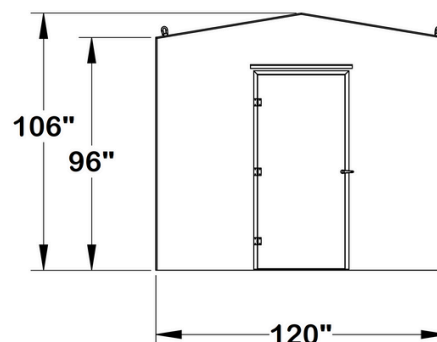

FRONT VIEW

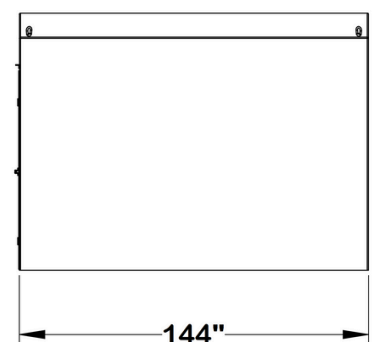

SIDE VIEW

VPC 10 X 12

One piece molded building with door and stainless-steel hardware.

Dimensions

Length: 144 IN

Width: 120 IN

Height: 106 IN

Door Opening Width: 36 IN

Door Opening Height: 80 IN

Standard Features

- 3" internal mounting flange
- Isophthalic polyester resin
- UV-resistant gel coat (interior & exterior)
- Rigid polyisocyanurate insulation (R7 per inch)
- Integral base mounting flange (internal or external, model dependent)

Common Optional Features

- Load Center
- External Fixed Louvers
- Light w/ Wall Switch
- 3/8" Integral Fiberglass Floor
- Laminated Plywood Interior in Walls/Roof
- Wall Mounted Unistrut
- Windows
- Double Doors

Standard Buildings

FRP Building: VPC 12 X 14



2D DRAWINGS:

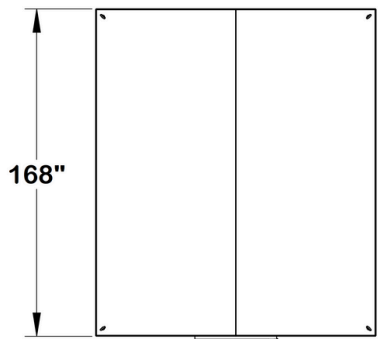

TOP VIEW

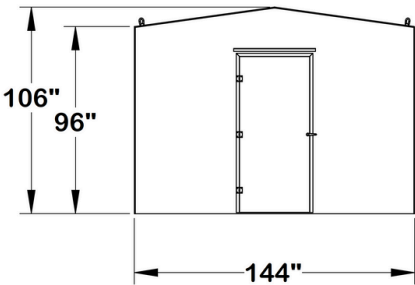

FRONT VIEW

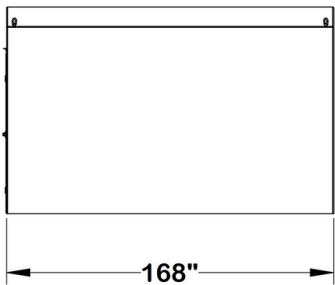

SIDE VIEW

VPC 12 X 14	
One piece molded building with door and stainless-steel hardware.	
Dimensions	
Length: 168 IN Width: 144 IN Height: 106 IN Door Opening Width: 36 IN Door Opening Height: 80 IN	
Standard Features	Common Optional Features
<ul style="list-style-type: none">• 3" internal mounting flange• Isophthalic polyester resin• UV-resistant gel coat (interior & exterior)• Rigid polyisocyanurate insulation (R7 per inch)• Integral base mounting flange (internal or external, model dependent)	<ul style="list-style-type: none">• Load Center• External Fixed Louvers• Light w/ Wall Switch• 3/8" Integral Fiberglass Floor• Laminated Plywood Interior in Walls/Roof• Wall Mounted Unistrut• Windows• Double Doors



Customized / Modular Fiberglass Buildings

ENGINEERED TO ENDURE, DESIGNED TO PROTECT.

VPC **Customized Fiberglass Buildings** are engineered for durability, security, and long-term performance — even in the harshest environments.

- **Built to Order:** Each structure is custom-designed to match your specific size, layout, and access requirements.
- **Durable Materials:** Constructed from corrosion-resistant, low-maintenance fiberglass.
- **Industry Applications:** Ideal for housing critical equipment in:
 - Water and wastewater treatment*
 - Utility installations*
 - Industrial facilities*
- **Reliable Performance:** Rugged construction and flexible design options ensure a dependable, long-lasting solution tailored to your project.

Product Details

Our custom buildings have been utilized to house power systems, radar installations, telecommunications equipment, and a wide range of instrumentation. When chemical or environmental challenges arise, our experienced team delivers advanced fiberglass solutions, leveraging state-of-the-art technology and expertise to provide durable, reliable structures tailored to your specific needs.

Specifications	
MINIMUM One-Piece Molded Size	4 x 3 FT
MAXIMUM One-Piece Molded Size	14 x 20 FT
Modular Construction	Constructed in Size at 20 ft. W and No Limitation on Length.
Material	Fiberglass

Applications



CHEMICAL FEED SHELTER



MAINTENANCE EQUIPMENT



PHOSPHORUS REMOVAL SHELTERS



COMMUNICATIONS SHELTERS



CUSTOM PUMP ENCLOSURES



NOISE REDUCTION SHELTERS

PACKAGED PUMP SKID COVER

EQUIPMENT BUILDING

WELL HEAD COVER

CHEMICAL FEED PUMP SHELTER

WATER PUMP COVER

IN GROUND VAULT

Custom Built. Purpose Fit.

Available options and upgrades



HVAC

We design HVAC systems to provide efficient climate control, even in the harshest environments. Each system is customized to fit the size, function, and ventilation needs of your fiberglass structure, featuring components such as a **heating and cooling unit**, **fixed louver ventilation**, a **corrosion-resistant exhaust fan**, and other available options.



LIGHTING

Custom lighting packages to ensure reliable illumination in any environment. Each system is tailored to your fiberglass building's layout and use, with options like **vapor-tight LED fixtures** and **durable tumbler switches** for long-lasting, weather-resistant performance.



DOORS, WINDOWS & ACCESS

We offer customizable doors, windows, and access points, including single or double doors, wall- or door-mounted windows, hydraulic closers, and various locks for secure access.



THERMOSTAT

Easy-to-use thermostats provide precise temperature control for fiberglass buildings.



ELECTRICAL PACKAGES

Our electrical packages can be tailored to meet your project's needs. Options include:

- **Wiring:** Standard or heavy-gauge wiring to support a variety of equipment.
- **Conduit:** Available in multiple materials and ratings for added durability and protection.
- **Load Centers:** Ranging from basic configurations to higher-capacity panels with single- or three-phase options.
- **Outlets:** Standard, GFCI, and specialty outlets for both interior and exterior use.



Custom Built. Purpose Fit.

Available options and upgrades

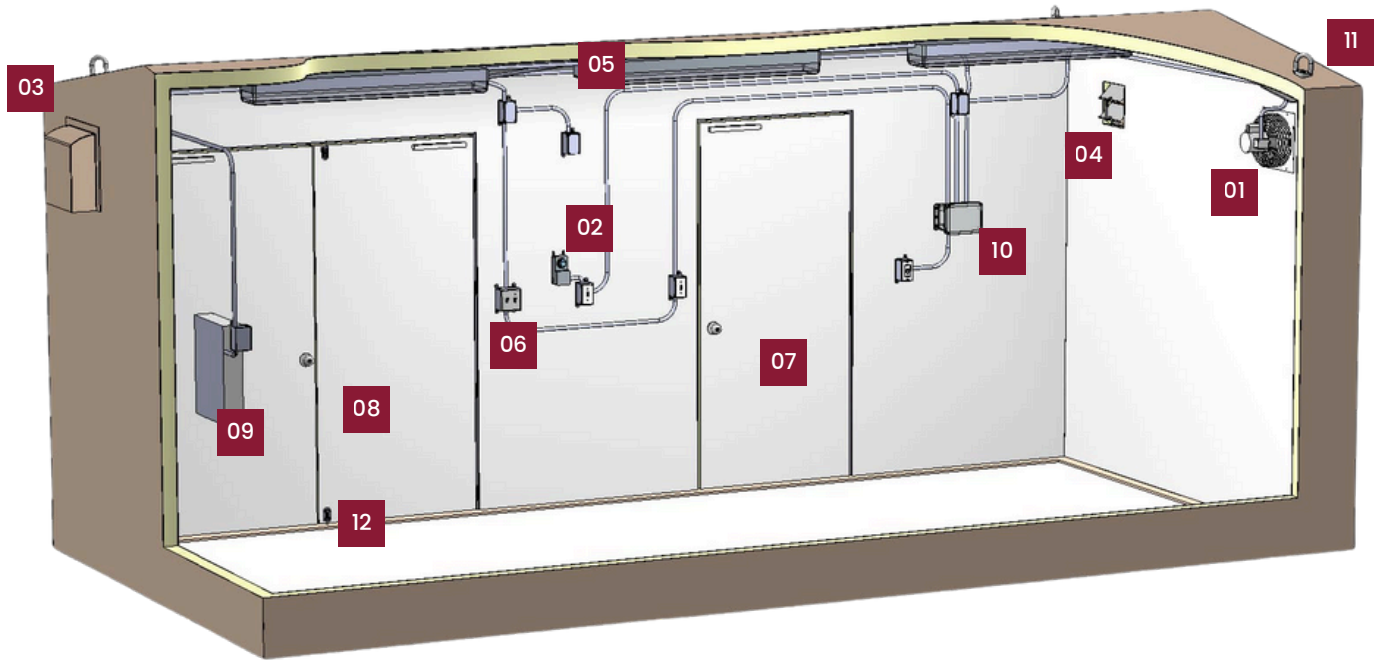

ADDITIONAL CUSTOMIZATION OPTIONS AND EQUIPMENT (DETAILED)

- 01 FAN**
- 02 THERMOSTAT**
- 03 RAIN HOOD FOR VENT COVERAGE**
- 04 LOUVER**
- 05 LED LIGHTING**
- 06 LIGHT SWITCH**
- 07 SINGLE DOOR**
- 08 DOUBLE DOOR**
- 09 ELECTRICAL PANEL**
- 10 JUNCTION BOX**
- 11 EYE HOOKS FOR LIFTING**
- 12 FOOT AND CHAIN BOLT**

- Fiberglass Floor with Insulation
- Fiberglass Containment Floor
- Self-Extinguishing Construction (CLASS A - FLAME SPREAD 20-25 PER ASTM E-84)
- Chemical Resistant or Other Specialized Gel Coat
- Custom Color Selection (white is standard)
- Additional Wall Height
- Partition Walls
- Increased Insulation **up to 6"+ (R-24)**
- Door Latch, Three-point, Pad Lockable Stainless-steel
- Panic/Push Bar Door Hardware
- Fixed or Sliding Wall Windows
- Hatches, Bulkheads, and Cutouts
- Mounting Channels/Unistrut (FRP/SS/Galvanized)
- Intake/Exhaust Fans
- Louvers/Dampers
- Fluorescent Lighting
- Incandescent Lighting
- Duplex Switch Box
- Duplex Switch Box with Weatherproof (for exterior)
- Door-Activated Switch
- Wall/Ceiling Mounted Heater w/ Thermostat and Tip-over Switch
- HVAC Wall Units - BTU as required
- Duplex Fuse Boxes
- Electrical Wiring
- Laminated Plywood Interior on Walls and/or Roof

Other Special Equipment Per Customer Requirements



ENCLOSURE WAS ENGINEERED TO WITHSTAND RISK CATEGORY IV FORCE WINDS.



Outfitted

Each building is fully equipped with electrical and ventilation systems, reflecting our dedication to delivering a comprehensive and practical design.



Case Example: Enclosure for Patrick Space Force Base



Custom FRP Pump Enclosure

Initially specified for a panelized construction, our team at VPC Fiberglass engineered an advanced solution: prefabricated single-piece molded FRP shelters. This design meets all performance criteria and provides a superior product with seamless construction, eliminating the need for additional on-site assembly.



THE BUILDING FEATURES A HIGH-PERFORMANCE COMPOSITE STRUCTURE WITH INNER AND OUTER FRP SKINS AND A 3" INSULATION CORE.



Case Example: Metering Chlorination Building



Outfitted

A heavy-duty electrical package was custom-designed for this unit, including:

- 125A 120/240V Main Lug Load Center (12-space, NEMA 1) for managing critical electrical circuits
- 48" interior LED panel lights for bright, energy-efficient illumination
- Exterior LED Light with integrated photocell for dusk-to-dawn security lighting
- Durable weatherproof light switches

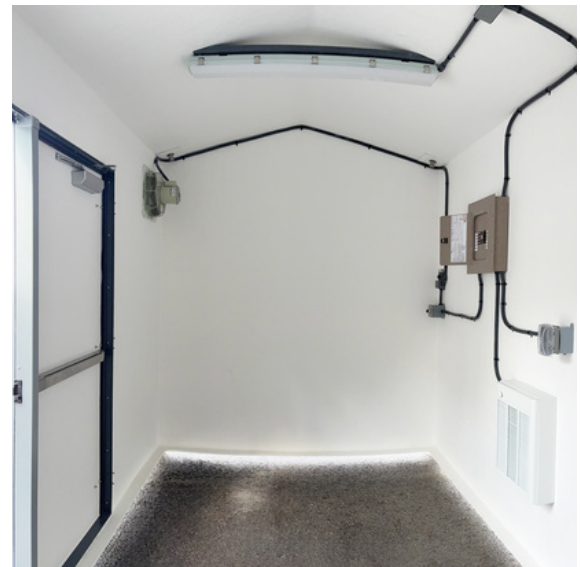

Custom FRP Metering Chlorination Building

This project features a custom-engineered fiberglass building specifically designed for use as a **Metering Chlorination Facility**. It was engineered to be mounted on top of a new concrete valve vault structure. The building provides access to the vault's hatch while also housing a **duplex chemical feed skid** with chemical feed pumps, monitoring equipment, a SCADA system, and an eye wash station.



585.735.9668

Version 1 • September 2025

Production Facility

10478 Ridge Road
Medina, New York 14103

Production Facility

222 South Niagara Street
Lockport, New York 14094

Administrative Office

2410 North Forest Road
Suite 301
Getzville, New York 14068



VPCFIBERGLASS.COM